

SPORT-T

GIVI®



This line of semi-rigid motorcycle bags has been designed for "fast touring".
With their compact sizes, medium to medium-small load capacities,
sporty lines and technical fabrics, these motorcycle bags
adapt perfectly to road bikes as well as sport touring motorcycles

ST605C – TANCKLOCK



Borsello da serbatoio TanklockED, 5 lt.
Da abbinare necessariamente alle flange
specifiche BF_ _

TanklockED tank bag, 5 lt. To match with
motorcycle specific mounting ring (BF_ _)

INFO

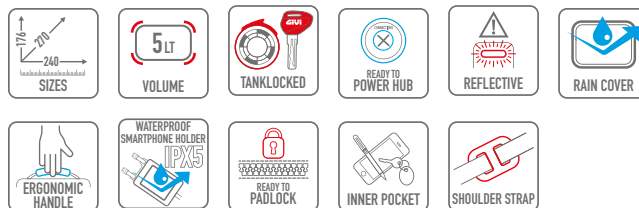

ISTRUZIONI DI MONTAGGIO – MOUNTING INSTRUCTIONS
INSTRUCTIONS DE MONTAGE – BAUANLEITUNG
INSTRUCCIONES DE MONTAJE – INSTRUÇÕES DE MONTAGEM

GIVI

ST605C – TANCKLOCK

SMARTPHONE HOLDER

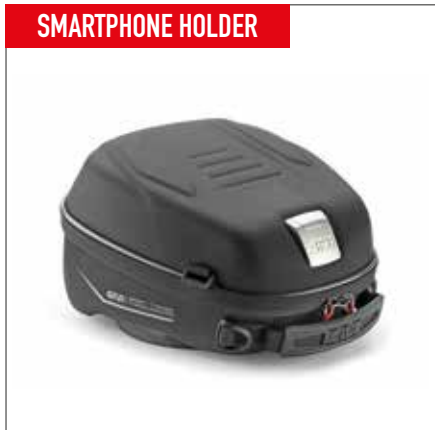

SHOULDER STRAP



RAIN COVER



OPTIONAL



S111 + S110

Kit Power Hub + presa elettrica 12v

Kit Power Hub + 12v electrical handlebar outlet

ATTENZIONE: Verificare il corretto aggancio delle borse prima di mettersi in marcia.
WARNING: Fasten the bags before march off.
ATTENTION : Vérifier la bonne accroche des sacoches avant la mise en route.
ACHTUNG: Prüfen Sie bitte die Befestigung der Taschen bevor Sie fahren
ATENCIÓN: Comprobar si esta correcto el anclaje de las bolsas antes de ponerse en marcha.
ATENÇÃO: Verifique se há adequada fixação dos sacos antes de começar.



ST605C - TANCKLOCK

TANKLOCKED SYSTEM

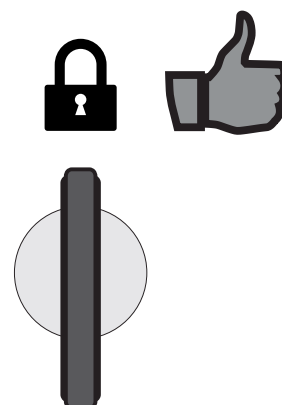
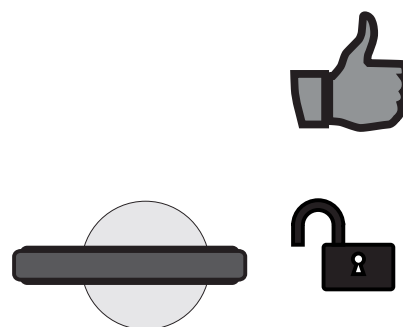

ST605C – TANCKLOCK

TANKLOCKED SYSTEM

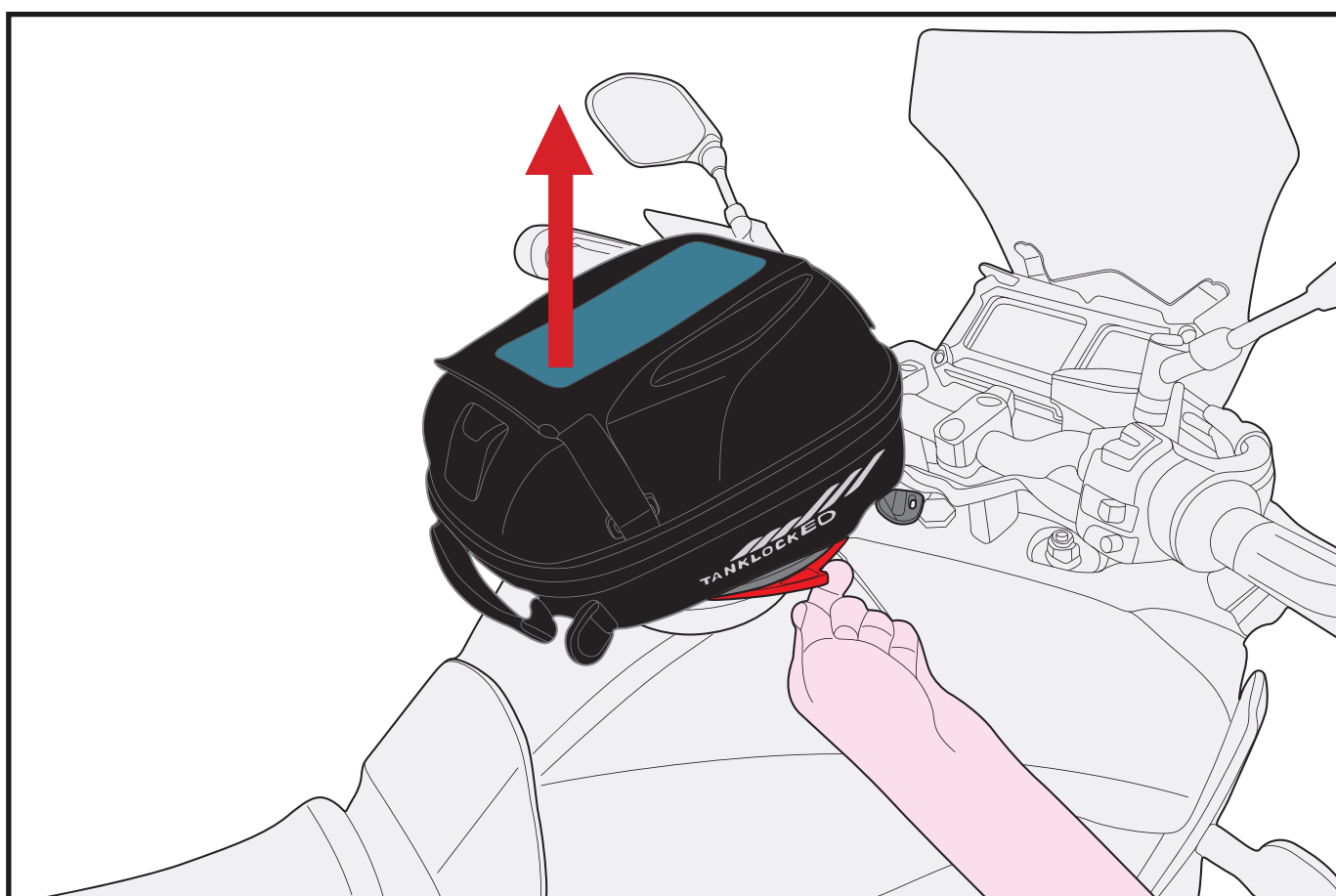

Con la chiave girata in posizione orizzontale ovvero di apertura, è possibile rimuovere la borsa dalla flangia sulla moto.

With the key turned horizontally (in the open position), it is possible to remove the bag from the flange on the bike.

Quand la clef est tournée horizontalement (dans la position ouverte),
il est possible de décrocher la sacoche de la bride qui est sur la moto

Con la llave girada en posición horizontal de apertura, es posible quitar la bolsa del aro de la moto.

Wenn der Schlüssel horizontal gedreht wird (in geöffneter Position),
können Sie die Tasche vom Befestigungsring am Motorrad entfernen.

Com a chave na posição horizontal (posição aberta), é possível remover a bolsa da flange na motocicleta.

ST605C – TANCKLOCK

TANKLOCKED SYSTEM

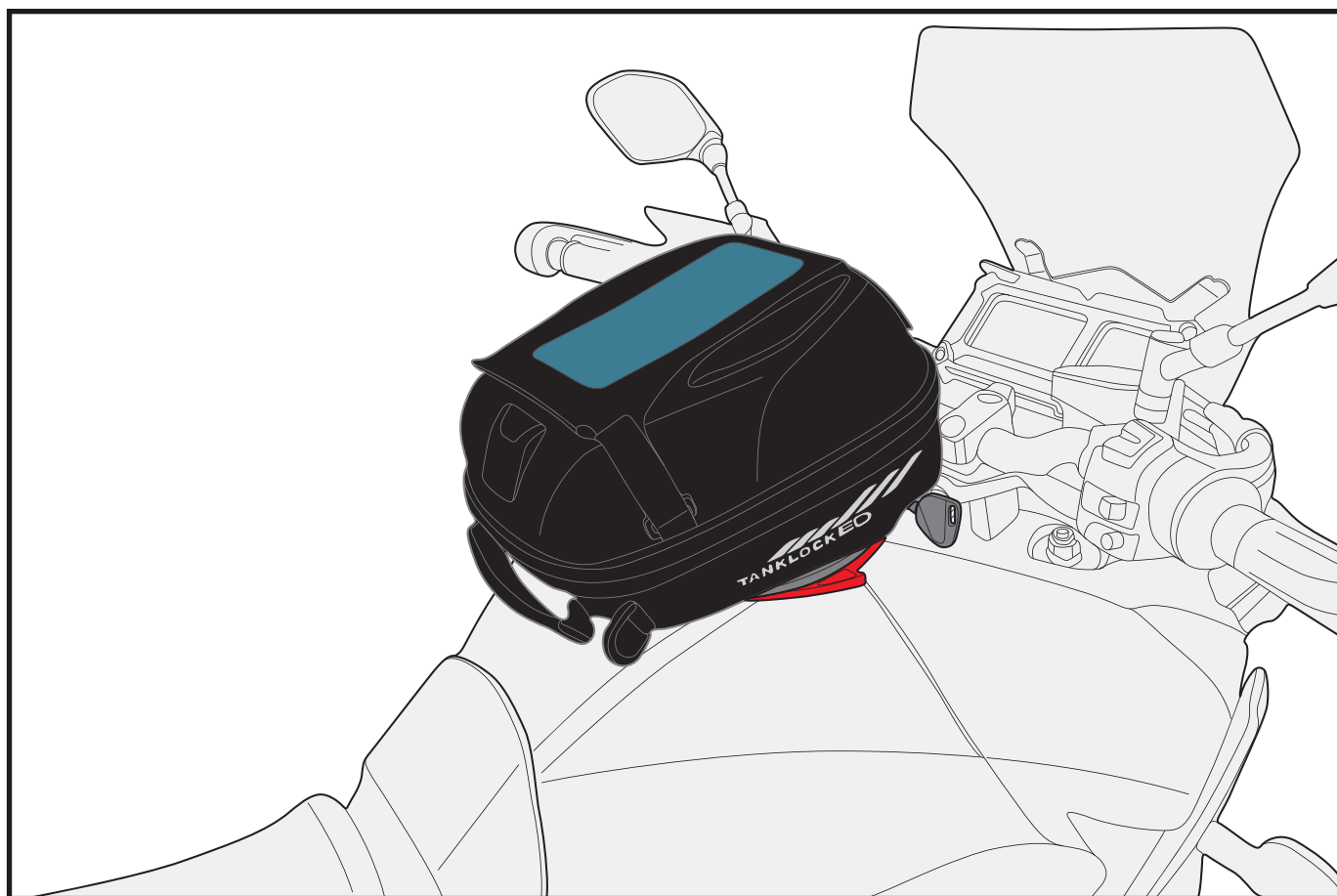

Con la chiave girata in posizione orizzontale ovvero di apertura, non è possibile rimuovere la borsa dalla flangia sulla moto.

With the key turned horizontally (in the open position), it is not possible to remove the bag from the flange on the bike.

Quand la clef est tournée horizontalement (dans la position ouverte),
il n'est pas possible de décrocher la sacoche de la bride qui est sur la moto

Con la llave girada en posición horizontal de apertura, no es posible quitar la bolsa del aro de la moto.

Wenn der Schlüssel vertikal gedreht wird (in geschlossener Position),
können Sie die Tasche vom Befestigungsring am Motorrad nicht entfernen.

Com a chave na posição horizontal (posição aberta), não é possível remover a bolsa da flange na motocicleta.